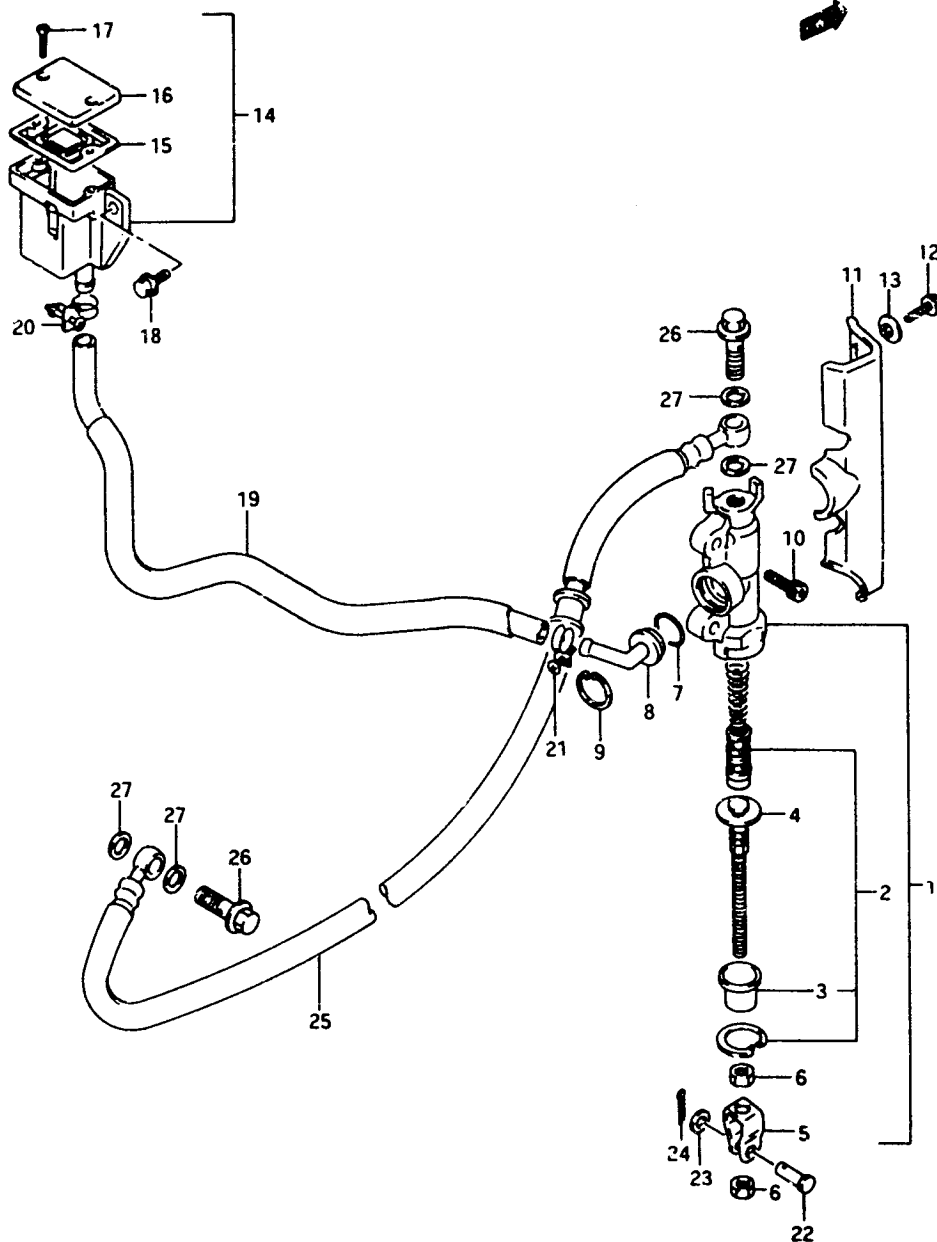

FIG.55

H - 10

87

FIG.55 (H-10) REAR MASTER CYLINDER



REF.NO.	PART NO.	DESCRIPTION	Q'TY	REMARKS
1-1	69600-45C00	CYLINDER ASSY, rear master	1	model L/M/N
1-2	69600-45C01	CYLINDER ASSY, rear master	1	model P/R
2	69600-04820	.PISTON/CUP SET	1	
3	69691-90A00	.BOOT	1	
4	69670-45C00	.ROD, push	1	
5	69692-22A00	.YOKE	1	
6	69693-22A00	.NUT	2	
7	69686-34200	.O RING	1	
8	69672-00B20	.CONNECTOR	1	
9	69674-00B20	.CIRCLIP	1	
10-1	07130-06205	BOLT	2	model L/M/N/P
10-2	07130-06203	BOLT	2	model R
11	69641-45C00	COVER, cylinder	1	
12-1	02142-06125	SCREW, cover	2	model L/M/N/P
12-2	02142-06123	SCREW, cover	2	model R
13	09169-06060	WASHER	2	
14-1	69740-24A00	TANK ASSY, rear reservoir	1	model L/M/N
14-2	69740-24A01	TANK ASSY, rear reservoir	1	model P/R
15	59667-04700	.DIAPHRAGM	1	
16-1	69669-24A01	.CAP	1	model L/M/N
16-2	59669-05D00	.CAP	1	model P/R
17	69689-04A00	.SCREW	2	
18-1	01517-06128	BOLT	1	model L/M/N/P
18-2	01550-06123	BOLT	1	model R
19	69731-45C00	HOSE, tank	1	
20	09400-16302	CLAMP, upper	1	
21-1	09400-15302	CLAMP, lower	1	model L/M/N/P
21-2	09400-14301	CLAMP, lower	1	model R
22	09200-06037	PIN	1	
23-1	08322-21067	WASHER	1	model L/M/N/P
23-2	08322-01063	WASHER	1	model R
24	04111-20158	PIN, cotter	1	
25-1	69480-45C00	HOSE, rear brake	1	model L/M/N
25-2	69480-45C10	HOSE, rear brake	1	model P/R
26-1	09360-10019	BOLT	2	model L/M/N/P
26-2	09360-10039	BOLT	2	model R
27	09161-10009	WASHER	4	

VX800R E2