

FIG.53

H-7

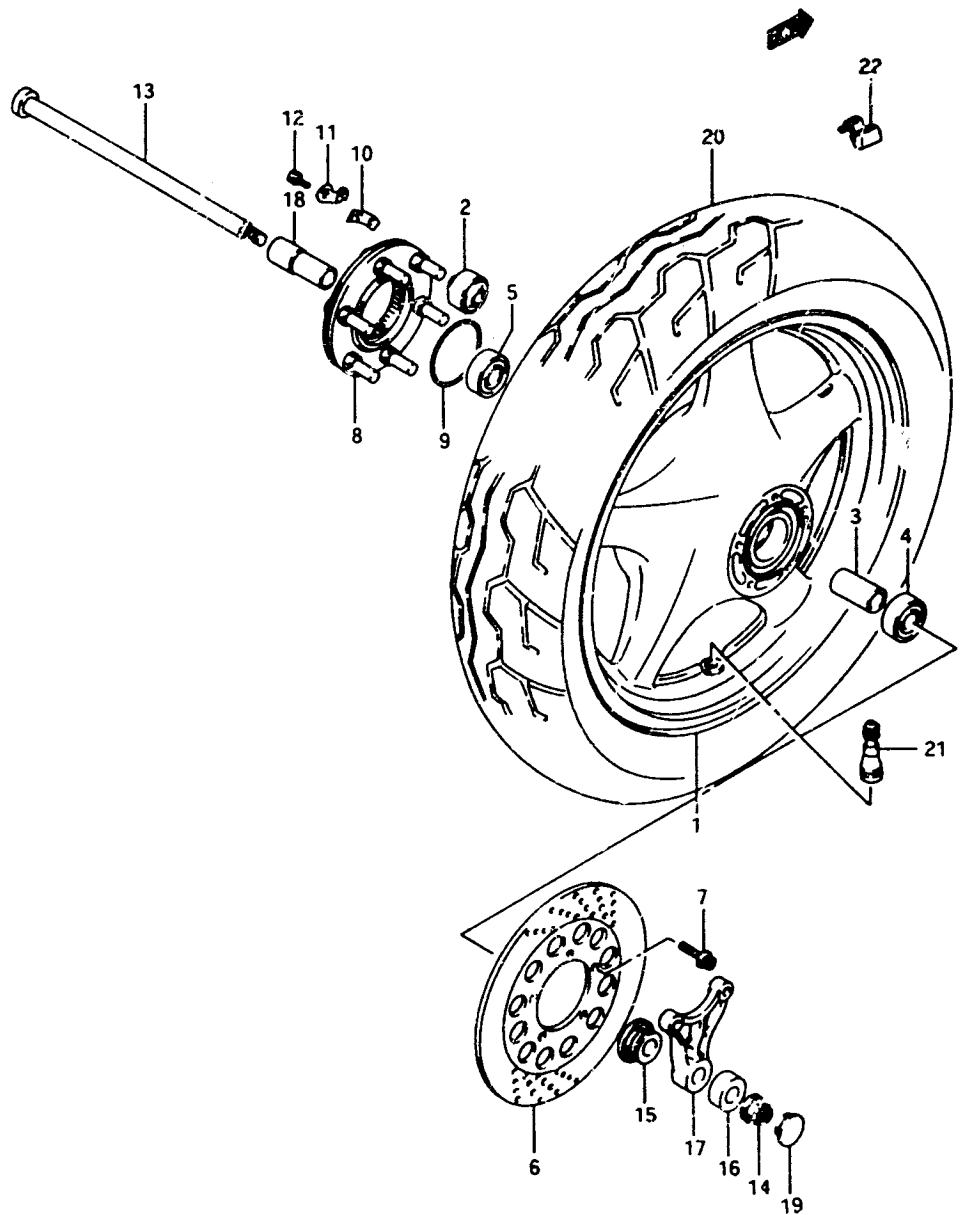

FIG.53 ( H- 7) REAR WHEEL

REF.NO.	PART NO.	DESCRIPTION	Q'TY	REMARKS
1-1	64100-45830-1/2	WHEEL SET, rear (MT3.50x17) Silver	1	model L/R +64100-45830-23/1
1-2	64100-45830-23W	WHEEL SET, rear (MT3.50x17) (Silver)	1	model M/N/P
2	09319-12019	.BUSHING	6	
3	09180-17099	SPACER, hub	1	
4	08123-63037	BEARING, RH	1	
5	08143-63037	BEARING, LH	1	
6-1	69211-45C00	DISC, rear brake (Silver)	1	model L
6-2	69211-45C10	DISC, rear brake (Black)	1	model M/N/P/R
7-1	07120-08308	BOLT	5	model L/M/N/P
7-2	09106-08131	BOLT	5	model R
8-1	64680-07A01	JOINT ASSY, hub driven	1	+64680-45113
8-2	64680-45113	JOINT ASSY, hub driven	1	
9	19280-65003	O RING	1	
10	64677-45110	WASHER, thrust	3	
11	09169-06030	WASHER	3	
12	09119-06049	BOLT	6	
13-1	64711-45C01	AXLE, rear	1	model L/M/N
13-2	64711-45C02	AXLE, rear	1	model P/R
14	08319-31148	NUT	1	
15-1	64740-31301	SPACER, axle RH	1	+64740-38800
15-2	64740-38800	SPACER, axle RH	1	
16	64741-45C02	SPACER, axle R/L	1	
17	69721-43400	BFACKET, caliper	1	
18	64772-34201	SPACER, axle LH	1	
19	64791-38800	CAP, axle RH	1	
20	65110-45C10	TIRE, rear (150/70 B17 69H) MEYZELER	1	Executed locally
21-1	43130-24A00	VALVE ASSY, wheel rim	1	+43130-24A11
21-2	43130-24A11	VALVE ASSY, wheel rim	1	
22-1	55411-00730	BALANCER (10g)	0-3	
22-2	55412-00A00	BALANCER (20g)	0-3	
22-3	55413-00A00	BALANCER (30g)	0-3	