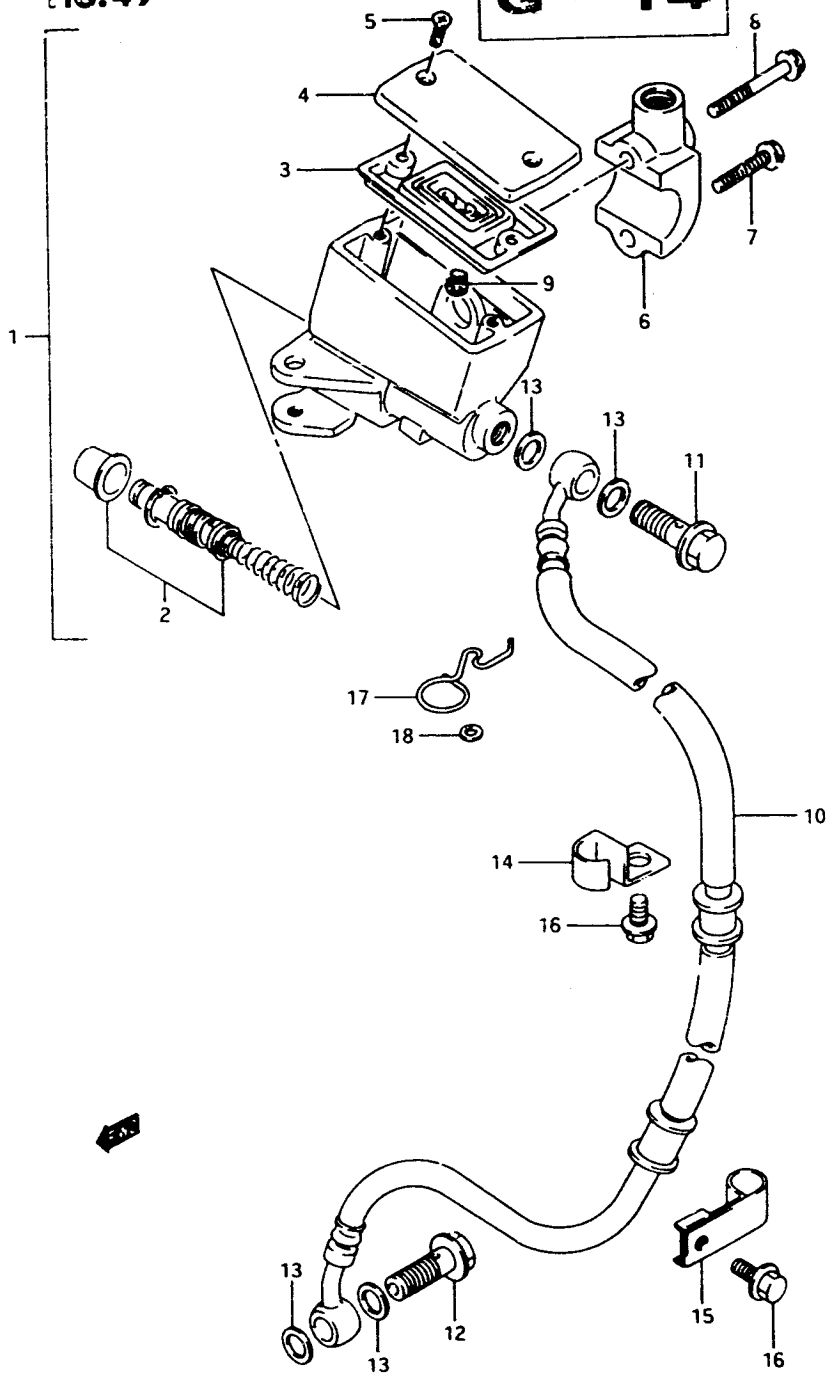

FIG. 49

G-14



77

FIG. 49 ( G-14) FRONT MASTER CYLINDER. (model L/M/N)  
QTY

REF. NO.	PART NO.	DESCRIPTION	QTY	REMARKS
1-1	59600-45C00	CYLINDER ASSY, front master (Atomic Silver)	1	model L
1-2	59600-45G20	CYLINDER ASSY, front master (Coronet Silver)	1	model M/N
2-1	59600-36820	.PISTON/CUP SET	1	model L
2-2	59600-04810	.PISTON/CUP SET	1	model M/N
3	59667-49460	.DIAPHRAGM	1	
4-1	59669-45C00	.CAP	1	model L
4-2	59669-45C10	.CAP	1	model M/N
5	69689-49300	.SCREW	2	
6-1	59671-45C00	.HOLDER	1	model L
6-2	59671-45C10	.HOLDER	1	model M/N
7	59675-19C00	.BOLT	1	
8	59675-19C10	.BOLT, upper	1	
9	59664-48800	.PROTECTOR	1	
10-1	59480-45C20	HOSE, front brake	1	E1
10-2	59480-45C10	HOSE, front brake	1	E2, E4, E15, E16, E17, E18, E21, E22, E24, E25, E34, E39
11	09360-10017	BOLT	1	
12	09360-10033	BOLT, lower	1	
13	09161-10009	WASHER	4	
14	59268-45C00	CLAMP, hose	1	
15	59268-01D10	CLAMP, hose	1	
16	01517-06125	BOLT	2	
17	59268-45C10	GUIDE, hose	1	
18	08322-21064	WASHER	1	

Refer to FIG. 49A(G-15) for model P/R