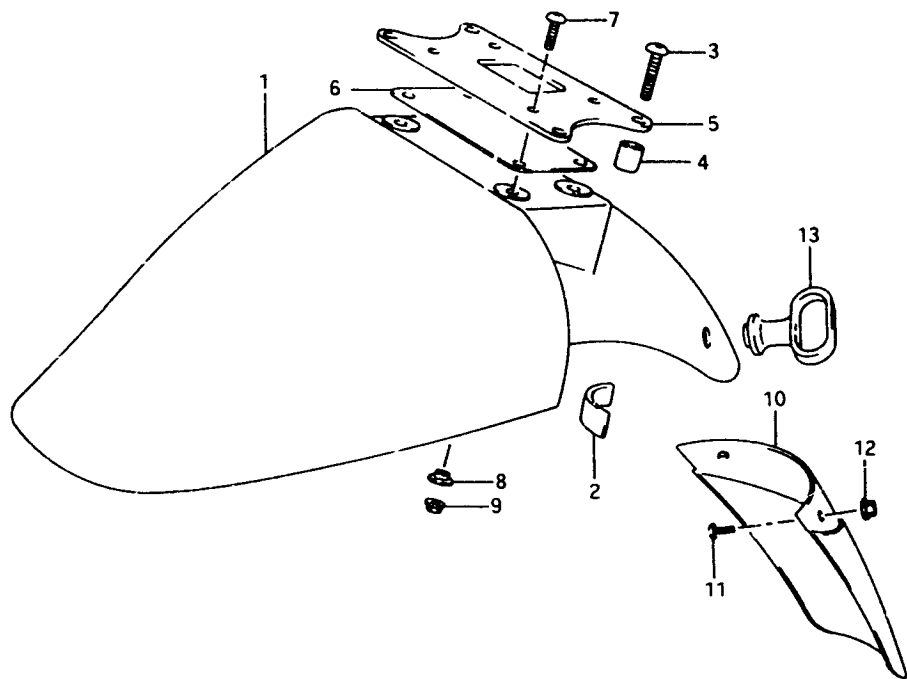

FIG.43

G - 8

71

FIG.43 (G- 8) FRONT FENDER



REF.NO.	PART NO.	DESCRIPTION	Q'TY	REMARKS
1-1	53111-32C31-24D	FENDER, front (Maroon)	1	model L
1-2	53111-32C31-24V	FENDER, front (Blue)	1	model L
1-3	53111-32C31-33J	FENDER, front (Black)	1	model L/M
1-4	53111-32C31-0FP	FENDER, front (Silver)	1	model M
1-5	53111-32C31-19A	FENDER, front (Red)	1	model M
1-6	53111-32C41-24D	FENDER, front (Maroon)	1	model L E22
1-7	53111-32C41-24V	FENDER, front (Blue)	1	model L E22
1-8	53111-32C41-33J	FENDER, front (Black)	1	model L/M E22
1-9	53111-32C41-0FP	FENDER, front (Silver)	1	model M E22
1-10	53111-32C41-19A	FENDER, front (Red)	1	model M E22
1-11	53111-32C41-33J	FENDER, front (Black)	1	model N/P
1-12	53111-32C41-24D	FENDER, front (Maroon)	1	model N
1-13	53111-32C41-1HU	FENDER, front (Purple)	1	model N
1-14	53111-32C41-22U	FENDER, front (Maroon)	1	model P/R
1-15	53111-32C41-1TU	FENDER, front (Purple)	1	model R
2	94583-05C00	CUSHION, fender	2	
3	09139-06G42	SCREW, fender	4	
4	09180-06Z27	SPACER	4	
5-1	53114-45C01	BRACE, front fender	1	E1
5-2	53114-45C10	BRACE, front fender	1	E2, E4, E15, E16, E17, E18, E21, E22, E24, E25, E34, E39
6	53115-45C00	PLATE, front fender	1	E2, E4, E15, E16, E17, E18, E21, E22, E24, E25, E34, E39
7	09139-05O42	SCREW, brace	4	
8	09169-05O09	WASHER	4	
9-1	08319-31O56	NUT	4	+08319-31O53
9-2	08319-31O53	NUT	4	
10	53311-45C10	EXTENSION, front fender	1	
11-1	02142-05128	SCREW	2	model L/M/N/P
11-2	02142-05123	SCREW	2	model R
12-1	08313-21O55	NUT	2	model L/M/N/P
12-2	08313-20O53	NUT	2	model R
13	58621-21203	GUIDE, cable	1	