

FIG. 11

C-5

16

FIG. 11 (C-5) CARBURETOR (REAR)

REF. NO.	PART NO.	DESCRIPTION	Q'TY	REMARKS
	13220-45CA0	CARBURETOR ASSY, rear	1	E1,model L E16
	13220-45C00	CARBURETOR ASSY, rear	1	E2,E4,E21,E25,E34 model L E15,model M/N E16
	13220-45C70	CARBURETOR ASSY, rear	1	E17
	13220-45C30	CARBURETOR ASSY, rear	1	E18
	13220-45C50	CARBURETOR ASSY, rear	1	E22,E24,E39 model M/N E15
	13220-45C60	CARBURETOR ASSY, rear	1	VX800UL/UM/UN/UP E22
	13220-45CA0	CARBURETOR ASSY, rear	1	VX800UR E22
1	13604-44080	.SCREW	2	
2	13551-45C00	.VALVE, throttle (115)	1	
3-1	13500-38A10	.DIAPHRAGM ASSY	1	
3-2	13500-45C10	.DIAPHRAGM ASSY	1	E18
4	13503-38800	.SPRING	1	
5	02112-03066	.SCREW	2	
6	08321-21036	.LOCK WASHER	2	
7	13387-47010	.RING	1	
8	13394-10010	.E RING	1	
9	13388-44030	.SPRING	1	
10	13389-37400	.PLATE	1	
11	13502-45C00	.COVER	1	
12	13251-38A10	.GASKET	1	
13	13382-44030	.WASHER	1	
14-1	09492-47013	.JET, pilot (47.5)	1	
14-2	09492-45016	.JET, pilot (45)	1	E18
15-1	13383-45C10	.NEEDLE, jet (5F109-3)	1	
15-2	13383-45CA0	.NEEDLE, jet (5F107-3)	1	E18
16-1	09491-27009	.JET, main (135)	1	E1,E16,E17,E18, VX800UL/UM/UN/UP E22
16-2	09491-26012	.JET, main (132.5)	1	E2,E4,E15,E21,E22,E24,E25, E34,E39
17	13332-44080	.WASHER	1	

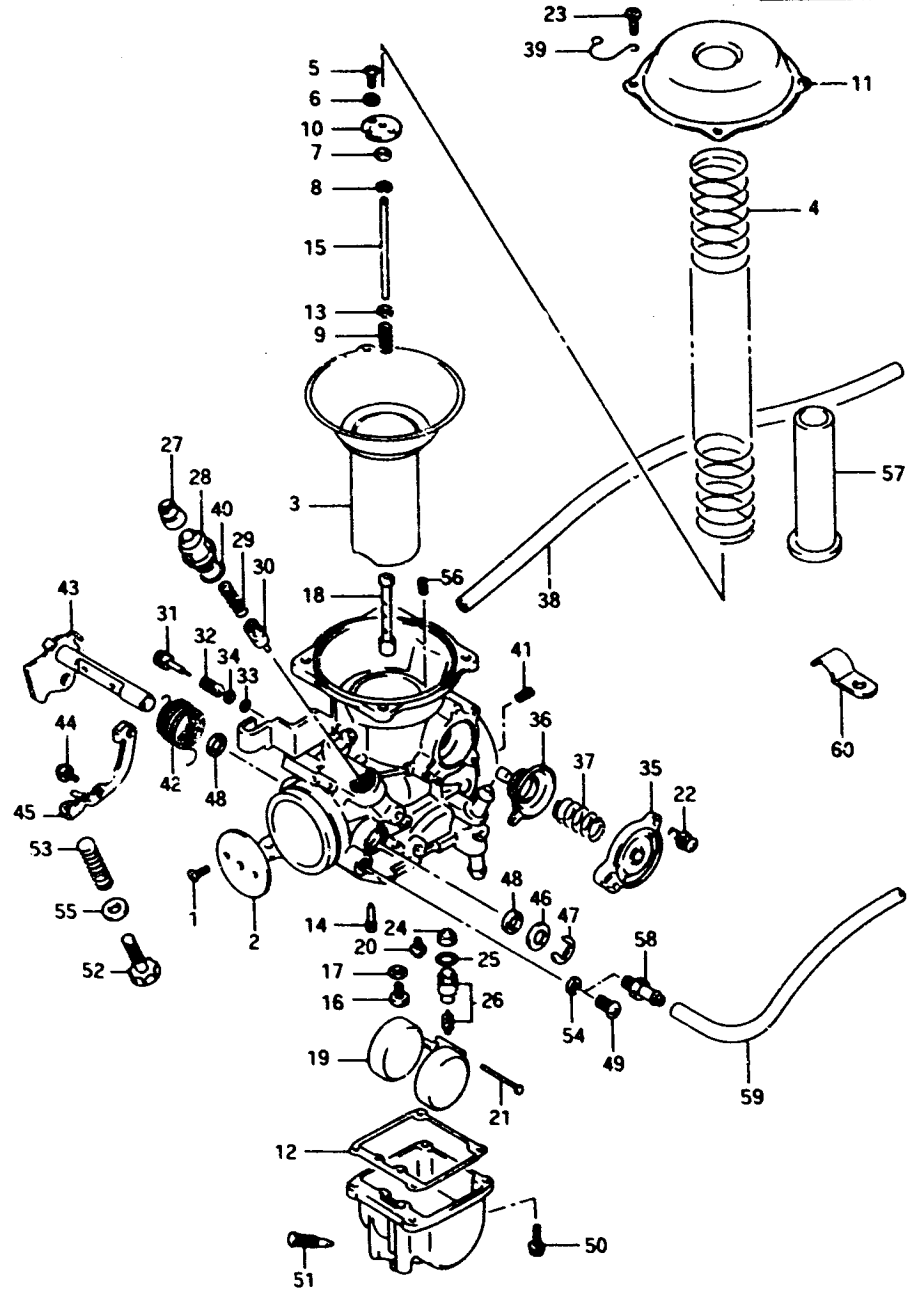

Note : The component part for VX800UR E22 spec, will be announced later by supplementary issue. So please do not use the parts number for VX800UR E22 spec. in this page.

AIR CLEANER.....	C-8	CYLINDER.....	B-8	FUEL COCK.....	F-10	OPTIONAL.....	B-12	SEAT.....	F-11	WIRING HARNESS.....	E-16
BATTERY.....	E-4	CYLINDER HEAD.....	B-2	FUEL TANK.....	F-8	PROPELLER SHAFT.....	D-9	SECOND DRIVE GEAR.....	D-6		
CAN CHAIN.....	B-13	ELECTRICAL.....	E-5	GEAR SHIFT.....	D-7	RADIATOR.....	C-13	SPEEDOMETER.....	E-6		
CANCHAFT.....	B-16	FASTENERS.....	F-2	MAIN SHAFT.....	F-1	BB CALIBER.....	C-13	STAND.....	F-5		

VX800R E2