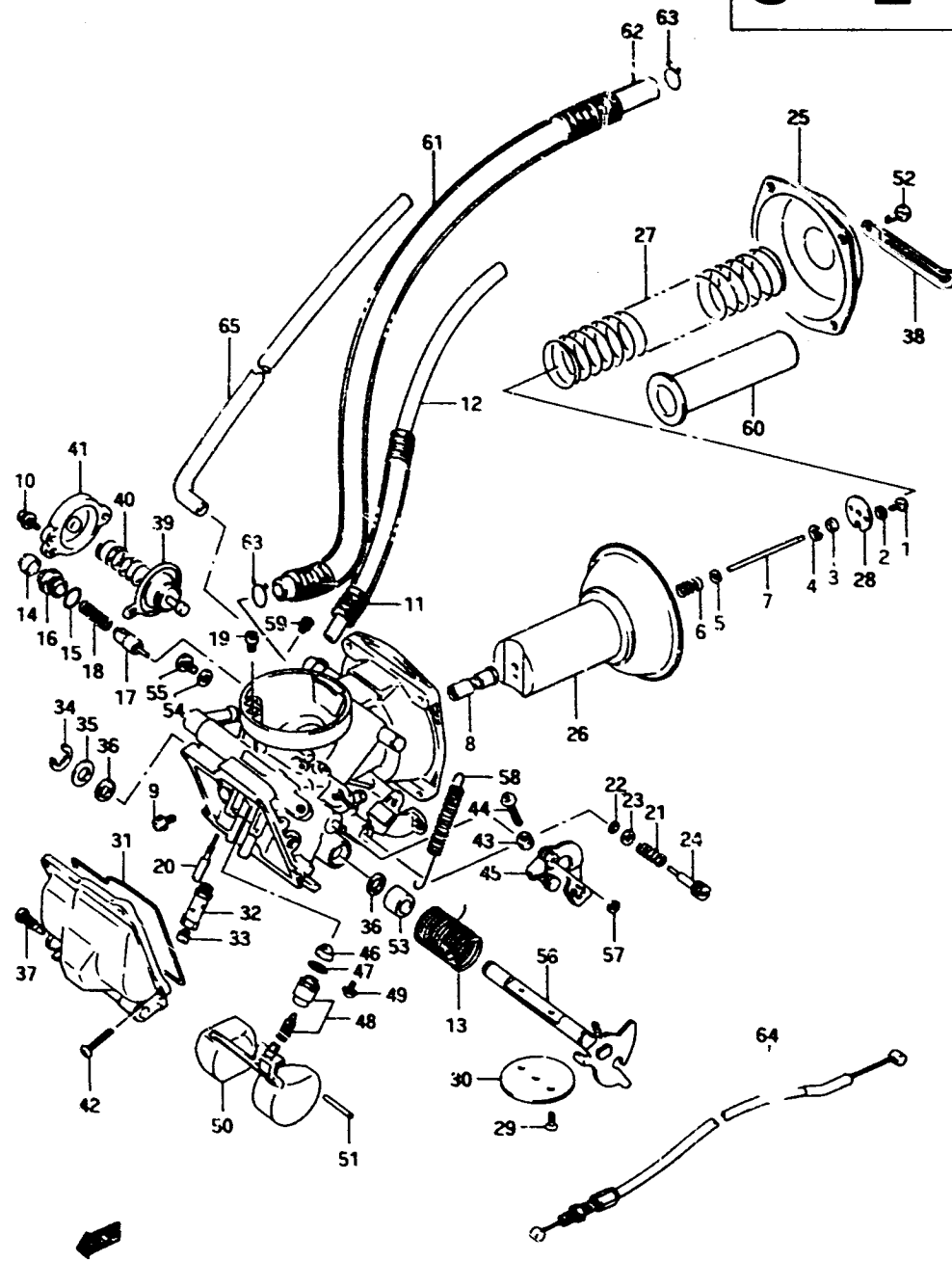

FIG.10

C - 2

13

FIG.10 (C- 2) CARBURETOR (FRONT)



REF.NO.	PART NO.	DESCRIPTION	Q'TY	REMARKS
	1310-45CA0	CARBURETOR ASSY, front	1	E1,model L E16
	13210-45C00	CARBURETOR ASSY, front	1	E2,E4,E21,E25,E34 model L E15,model M/N E16
	13210-45C70	CARBURETOR ASSY, front	1	E17
	13210-45C30	CARBURETOR ASSY, front	1	E18
	13210-45C50	CARBURETOR ASSY, front	1	E22,E24,E39 model M/N E15
	13210-45060	CARBURETOR ASSY, front	1	VX800U/L/M/UN/UP E22
	13210-45CA0	CARBURETOR ASSY, front	1	VX800UR E22
1	02112-03066	.SCREW	2	
2	08321-21036	.LOCK WASHER	2	
3	13537-47610	.RING	1	
4	13394-13010	.F. RING	1	
5	13382-44030	.WASHER	1	
6	13388-44030	.SPRING	1	
7-1	13383-45C00	.NEEDLE, Jet (5049-3)	1	
7-2	13383-45C50	.NEEDLE, Jet (5048-3)	1	E18
8-1	09494-00592	.JET, needle (P-4)	1	+09494-00686
8-2	09494-00688	.JET, needle	1	model L/M E17
8-3	09494-00592	.JET, needle (P-4)	1	model N/P E17
8-4	09494-00588	.JET, needle (P-2)	1	E18
9	13605-38800	.SCREW	1	
10	13602-19850	.SCREW	2	
11	13684-45C20	.HOSE	2	
12	13684-38A20	.HOSE (5x8x225-150)	1	
13	13573-38800	.SPRING	1	
14	13681-04010	.CAP	1	
15	13278-47090	.O RING	1	
16	13418-43410	.HOLDER, guide	1	
17	13471-01400	.PLUNGER	1	

Note : The component part for VX800UR E22 spec, will be announced later by supplementary issue. So please do not use the parts number for VX800UR E22 spec. in this page.